



HOMM  
SINGLE

# ABOUT SINGLE

SINGLE is a fully equipped, modern small house, designed for permanent living.

In terms of functionality SINGLE can compete with much larger houses, due to its rationally designed layout.

Large windows connect living room with spacious outdoor terrace. Intelligent architectural solutions help maintain privacy, allowing you to feel both cozy and completely free.

In SINGLE, you will find a spacious living room, a functional kitchen, a bathroom, a wardrobe and many more features designed for modern living. Our cooperating with reliable partners ensures high quality and durability of equipment and appliances installed in SINGLE.

Just like all HOMM models, SINGLE is very cost-efficient. Advanced utility infrastructure ensures low electricity consumption every day at any time of the year.

SINGLE is great for small city spaces but would also fit in well in a natural setting. Thanks to its neat architecture, it is a perfect fuss-free alternative to building a guest house. However, we guarantee that as well as being suitable for small spaces, it is also perfect for your countryside getaways. We use natural, eco-friendly materials, and the design blends in perfectly with the nature.

## WHAT MAKES HOMM SPECIAL



### Thermowood exterior cladding

No need to repaint, reoil – exterior doesn't need any care for decades!  
100% ecofriendly.



### Aluminum (3 glass layers) window frame

Warm, strong and long-lasting.



### Carbon floor heating system with wi-fi thermostat

You will be able to control Your heating system despite of being far away!



### Natural OAK flooring

Special construction for heated floors.



### Highly efficient recuperation system



### Smart house system

Controls heating system, boiler, and door lock.

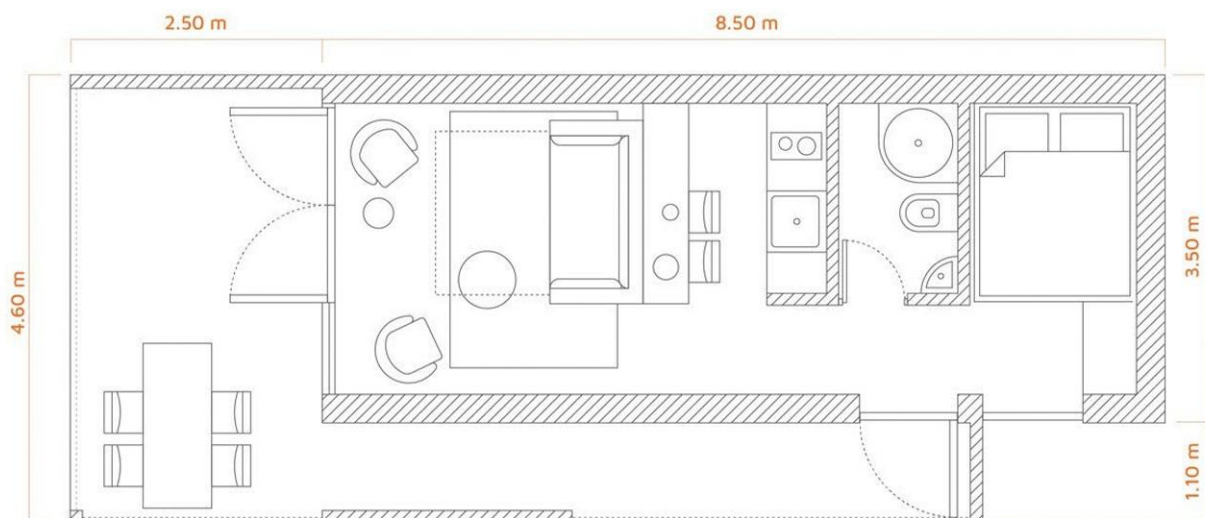

## GENERAL INDICATORS

### 1. Building type

Modular building

### 2. Parameters

No. of people in house:

**2** (permanent living) **or 4** (sleeping overnight)

**850 cm** (length) X **350 cm** (width) X **350 cm** (height);  
Building area (outer perimeter): **30,00 m<sup>2</sup>** (**without terrace**)

Floor area: **23,00 m<sup>2</sup>** (without entresol);

Terrace area: **18,00 m<sup>2</sup>**.

Inner height: **280 cm** (from floor to ceiling).

### 3. Weight

Standard: **10.900 Kg**

(empty, with inside and outside decorations, without terrace)

With interior equipment: **13.200 Kg**

Indicator can differ +/- 5%

### 4. Thermal resistance

- Walls:  $U = 0,15 \text{ W/ m}^2 \text{ K}$

- Roof:  $U = 0,14 \text{ W/ m}^2 \text{ K}$

Given minimal indicators.

## CONSTRUCTION DETAIL DESCRIPTION

### 5. Walls

Dried, calibrated wood (45x145+45x45) support construction is filled with Knauf mineral wool NATURBOARD 35  $\lambda D[W/mK]=0,035$  (ecofriendly) (20cm). Covered with wind resistant plate "Knauf GTS-9". The construction piece is full of thermal film and special rupture resistant plate. Outside interior – 125x26 mm A class pine tree siding (thermowood).

### 6. Roof

Dried, calibrated wood (45x245) support construction has an air gap. On top there are 2 layers of humidity resistant plate. Thermal insulation – 250 mm NATURBOARD 35  $\lambda D[W/mK]=0,035$  (ecofriendly).

The inner side is covered with thermal film, while the outside with wind resistant film ("Dupont Tyvek"). Roof covering: double layer bitumen heated cover.

### 7. Floor

Metal subframe, dried, calibrated wood (45x195) support construction is filled with NATURBOARD 35  $\lambda D[W/m-K]=0,035$  (20cm) + "Isover" RKL50 (5cm). Both interior and exterior is supported with 22mm thickness OSB 3 plate. Lower half is water-proof.

### 8. Internal partitions

Dried, calibrated wood (45x75) support construction is filled with mineral wool for acoustic reasons. Supported from inside and outside with rupture resistant plates.

### 9. Windows

Warm aluminum profile window frames with a double glass packet (three glass layers). Doors with push-down handle, aluminum threshold and can be locked.

### 10. Terrace

The house bottom frame is made from impregnated (deep impregnation method) wood. Terrace is made of coniferous thermowood with grooves and screwed with special conical wood screws. Includes metal subframe.

## INDOOR INTERIOR

### 11. Walls

Plastered (putty) and painted maximum resistant class washable matt paint. Color – warm white & dark grey. Bathroom decoration – limestone tiles 600x600 dark grey (matt).

### 12. Ceiling

Plastered (putty) and painted with white matt paint.

### 13. Floor

Natural oak floor deck.

Bathroom decoration – limestone tiles 600x600 dark grey (matt).

## ENGINEER PARTS

### 14. Electricity

Front panel with 220V power sockets + 2 pcs outside. LED track lighting system. Electric radiator in bathroom, electric ventilator. Carbon fiber floor heating system with programmable regulators (wi-fi control). Made by "ABB", "SIEMENS".

### 15. Sanitary ware / Plumbing

Shower, wash basin, toilet, shower faucet, water heating, ventilation system.

Made by "JIKA", "GROHE" and "LAUFEN".

## FURNITURE

### 16. Furniture

Kitchen furniture with sink, integrated fridge. Also includes all other kitchen equipment.

Made by Siemens, Franke, Electrolux, Bosch, or AEG.

## Devices

### 1. Wall lighting

“PHILIPS” LED IP20 or similar



### 2. Ceiling lighting

“PHILIPS” LED IP20 or similar



### 3. Bathroom lighting

5,5W 12X12 3000K  
LED  
Max. 5,5W  
IP20



### 4. Dining area lighting

- LED
- Max. 60W
- Material – metal



### 5. Outdoor lighting

- LED
- IP65



### 6. Lighting control

“JUNG”



### 7. Water heater

80 liters  
Ariston or Electrolux or similar



### 8. Towel dryer

Elonika or similar



### 9. Heating system

- Carbon heating film
- 80 W/m<sup>2</sup>
- Wi-fi control



### 10. Shower doors

JIKA or Ravak or similar



### 11. Shower equipment

GROHE thermostatic shower mixer



### 12. Toilet bowl

LAUFEN



### 13. Wash basin

LAUFEN with cabinet



### 14. Faucet

GROHE



### 15. Shower tray

RAVAK or JIKA or similar



### 16. Silent bathroom ventilation fan

- Soler & Palau or similar
- Ultra-plated exhaust design
- humidity sensor



### 17. Ventilation system

- Electrolux or Mitsubishi
- Smart wi-fi control



## Kitchen equipment

### 18. Furniture

- Custom HOMM made Complete kitchen, which includes scratch-resistant worktop, shelves, drawers, sink bowl, wash-basin mixer tap and water-trap.
- Smooth-running drawers with drawer stops.



### 19. Hob

- Siemens or Electrolux
- Induction hob for your hot meals.



### 20. Oven

- Siemens or Electrolux
- Electric oven with child-safety door lock.



### 21. Refrigerator

- Siemens or Electrolux
- Fridge with a freezer, integrated LED light technology. The door can be opened on the right or left side.



### 22. Oven hood

- Electrolux or AEG
- An extractor hood with all the basic functions you need.





## Any questions?

Contact us:

+370 616 94800

[welcme@homm.space](mailto:welcme@homm.space)