



HOMM
SINGLE

ABOUT SINGLE

SINGLE is a fully equipped, modern small house, designed for permanent living.

In terms of functionality SINGLE can compete with much larger houses, due to its rationally designed layout.

Large windows connect living room with spacious outdoor terrace. Intelligent architectural solutions help maintain privacy, allowing you to feel both cosy and completely free.

In SINGLE, you will find a spacious living room, a functional kitchen, a bathroom, a wardrobe and many more features designed for modern living. Our cooperating with reliable partners ensures high quality and durability of equipment and appliances installed in SINGLE.

Just like all HOMM models, SINGLE is very cost-efficient. Advanced utility infrastructure ensures low electricity consumption every day at any time of the year.

SINGLE is great for small city spaces but would also fit in well in a natural setting. Thanks to its neat architecture, it is a perfect fuss-free alternative to building a guest house. However, we guarantee that as well as being suitable for small spaces, it is also perfect for your countryside getaways. We use natural, eco-friendly materials, and the design blends in perfectly with the nature.

WHAT MAKES HOMM SPECIAL



Thermowood exterior cladding

No need to repaint, reoil – exterior doesn't need any care for decades!
100% ecofriendly.



Aluminum (3 glass layers) window frame

Warm, strong and longlasting.



Carbon floor heating system with wi-fi thermostat

You will be able to control Your heating system despite of being far away!



Natural OAK flooring

Special construction for heated floors.



Highly efficient heat recovery ventilation system

With SMART controllers.



Smart house system

Controls lighting, air ventilation, heating systems and more.

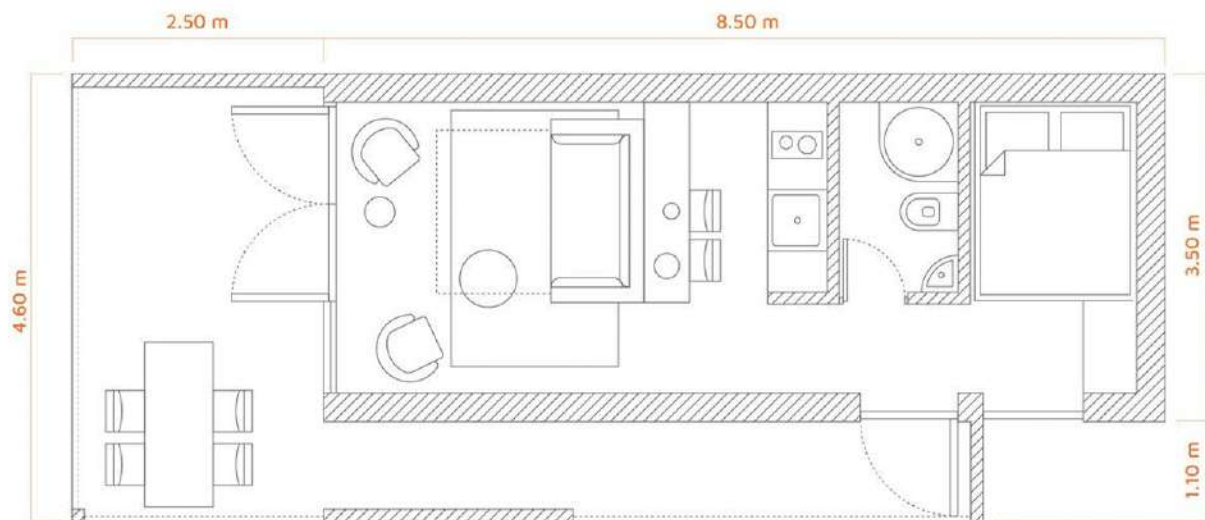

GENERAL INDICATORS

1. Building type

Modular building

2. Parameters

No. of people in house:

2 (permanent living) **or 4** (sleeping overnight)

850 cm (length) X **350 cm** (width) X **350 cm** (height);
Building area (outer perimeter): **30,00 m² (without terrace)**

Floor area: **23,00 m²** (without entresol);

Terrace area – **18,00 m²**.

Inner height – **280 cm** (from floor to ceiling).

3. Weight

Standard: **10.900 Kg**

(empty, with inside and outside decorations, without terrace)

With interior equipment: **13.200 Kg**

Indicator can differ +/- 5%

4. Thermal resistance

- Walls: $U = 0,15 \text{ W/ m}^2 \text{ K}$

- Roof: $U = 0,14 \text{ W/ m}^2 \text{ K}$

Given minimal indicators.

CONSTRUCTION DETAIL DESCRIPTION

5. Walls

Dried, calibrated wood (45x145+45x45) support construction is filled with Knauf mineral wool NATURBOARD 35 $\lambda D[W/mK]=0,035$ (ecofriendly) (20cm). Covered with wind resistant plate "Knauf GTS-9". The construction piece is full of thermal film and special rupture resistant "Knauf Diamant" plate. Outside interior – 125x26 mm A class pine tree siding (thermowood).

6. Roof

Dried, calibrated wood (45X245) support construction has an air gap. On top there are 2 layers of "Durelis Popuilar" humidity resistant plate. Thermal insulation – 250 mm NATURBOARD 35 $\lambda D[W/mK]=0,035$ (ecofriendly). The inner side is covered with thermal film, while the outside with wind resistant film ("Dupoint Tyvek"). Roof covering: double layer bitumen heated cover.

7. Ceiling

Metal subframe, dried, calibrated wood (45x195) support construction is filled with NATURBOARD 35 $\lambda D[W/mK]=0,035$ (20cm) + "Isover" RKL50 (5cm). Both interior and exterior is supported with 22mm thickness OSB 3 plate. Lower half is water-proof.

8. Internal partitions

Dried, calibrated wood (45x75) support construction is filled with mineral wool for acoustic reasons. Supported from inside and outside with "Knauf Diamant" plates.

9. Windows

Warm aluminum profile window frames with a double glass packet (three glass layers). Doors with push-down handle, aluminum threshold and can be locked.

10. Terrace

The house bottom frame is made from depth method impregnated wood. Terrace is made of coniferous thermowood with grooves and screwed with special conical wood screws. Includes metal subframe.

INDOOR INTERIOR

11. Walls

Plastered (putty) and painted maximum resistant class ceramic base washable matt paint. Color – warm white & dark grey. Bathroom decoration – limestone tiles 600x600 dark grey (matt).

12. Ceiling

Plastered (putty) and painted with white matt paint.

13. Floor

Natural oak floor deck.

Bathroom decoration – limestone tiles 600x600 dark grey (matt). Antistatic carpet cover on entresol and stairs.

ENGINEER PARTS

14. Electricity

Front panel 12 pcs of 220V power sockets + 2 pcs outside, 5 zone lighting control. Lighting transformers, LED track lighting system. Electric radiator in bathroom, electric ventilator. Carbon fiber floor heating system with programmable regulators (wi-fi control). Made by "ABB", "SIEMENS".

15. Sanitary ware / Plumbing

Shower, wash basin, toilet, shower faucet, water heating, ventilation system.

Made by "JIKA", "GROHE" and "LAUFEN".

FURNITURE

16. Furniture

LMDP kitchen furniture with integrated heater and sink, integrated fridge, produced by "IKEA".

Inside stairs, entresol railings. Also included all kitchen equipment.

Made by "SIEMENS", "FRANKE".

Devices

1. Wall lighting

„PHILIPS“ LED IP20



2. Ceiling lighting

„PHILIPS“ LED IP20



3. Bathroom lighting

FUEVA 1 5,5W 12X12 3000K

- LED
- Max. 5,5W
- IP20



4. Dining area lighting

- LED
- Max. 60W
- Material – metal



5. Outdoor lighting

„LUCIDE BOOGY“

- LED
- IP65



6. Lighting control

„JUNG“



7. Water heater

ARISTON VELIS EVO 80
Made in Italy



8. Towel dryer

„Elonika“ EE 370 SLMP



9. Heating system

- Carbon Heating Film „Dimat“
- 80W/m²;
- Wi-fi control



10. Shower doors

JIKA CUBITO PURE 90X195 MATT



11. Shower equipment

„GROHE GROHTHERM 800 AND TEMPESTA II“



12. Toilet bowl

LAUFEN PRO NORDIC



13. Wash basin

LAUFEN PRO S COMPACT 55X38 WITH CABINET



14. Faucet

„GROHE BAUEDGE“



15. Shower tray

„RAVAK“ GALAXY PERSEUS PRO-90 FLA



15. Bathroom ventilation fan

Soler & Palau (SILENT-100 CHZ):

- Ultra-plated exhaust design
- humidity sensor



16. Ventilation system

EPVS-200 Electrolux

- adjustable timer



Kitchen equipment

17. Furniture

„IKEA“ KNOXHULT 180x61x220 cm

- Complete kitchen, which includes scratch-resistant worktop, shelves, drawers, sink bowl, wash-basin mixer tap and water-trap.
- Smooth-running drawer with drawer stop.



18. Hob

„IKEA“ MÖJLIG

- Induction hob for your hot meals. 5 year guarantee.



19. Oven

„IKEA“ GÖRLIG

Electric oven with child-safety door lock. 5 year guarantee.



20. Refrigerator

„IKEA“ SVALKAS

- 5 year guarantee.
- Fridge with 3 adjustable shelves and a freezer, integrated LED light technology. The door can be opened on the right or left side.

Good to know -

Energy consumption: **151 kWh/year**

Net volume fridge: **109 l**

This product bears the CE mark.



19. Oven hood

„IKEA“ UTDRAG

An extractor hood with all the basic functions you need.





Any questions?

Contact us: